

SS92-B-60(50) - SPEEDLINE System Data Sheet - Version V1 (24-10-23)

Staggered SPEEDLINE 92mm 'I' Stud Partition
 @600mm Ctrs with 2x BG Gyproc 15mm
 SoundBloc each side, 50mm APR

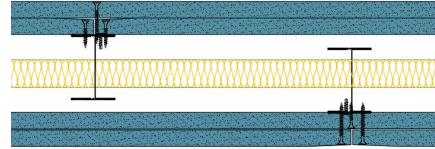

System Performance Breakdown

Fire Resistance:

BS476 Part 22:1987:

Test Ref & Date or Applied Ref & Report:

Max Height:

Thickness:

Duty Grade: BS 5234: Part 2:1992:

Sound Insulation:

90/90 Minutes (Integrity/Insulation).

BRE Report P102396-1011A

Refer to Speedline Specification Clause

208 mm. (At Base Track, Excluding Finishes)

Severe - Annexes A-F

61 R_w dB, -6Ctr Date Tested or Assessed Against - 08/02/2013

Test Code:
H18047AA
Test Date:
08/02/2013

Freq. Hz	R dB
50	27.9
63	29.6
80	30.5
100	41.8
125	39.7
160	47.4
200	50.8
250	52.7
315	56.2
400	60.5
500	64.1
630	64.7
800	67.5
1 000	68.1
1 250	71.0
1 600	68.8
2 000	62.2
2 500	56.1
3 150	57.6
4 000	61.3
5 000	64.4
6 300	
8 000	
10 000	

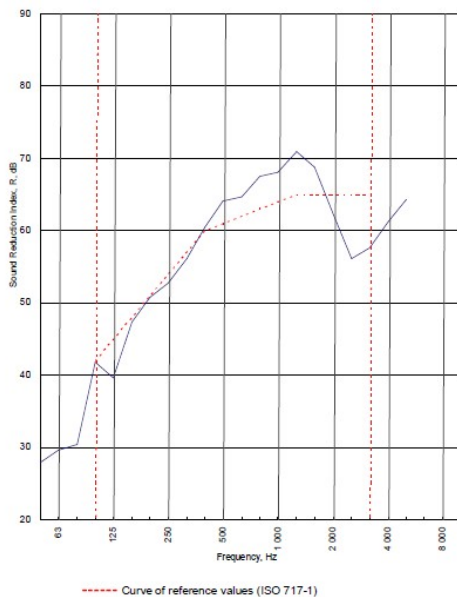

Rating according to BS EN ISO 717-1:1997 **R_w (C;Ctr) = 61 (-2;-6) dB**
 Max dev. 8.9 dB at 2 500 Hz

Evaluation based on laboratory measurement results obtained by an engineering method:

$C_{50-3150}$ = -4 dB	$C_{50-5000}$ = -4 dB	$C_{100-5000}$ = -2 dB
$C_{0-500-1500}$ = -14 dB	$C_{0-500-5000}$ = -14 dB	$C_{0-100-4000}$ = -6 dB

TESTED AT ONE OF THE UKAS ACCREDITED LABORATORIES BELOW

- B.T.C (H-Ref on Graph)
- B.R.E
- AIRO
- S.R.L

Customer: Metsec plc Hepsac Division



BTC 18047A: Page 9 of 12